



Soak up the sun

Hills APOLLO™
FLAT PANEL SOLAR HOT WATER SYSTEMS



Hills APOLLO™

FLAT PANEL SOLAR HOT WATER SYSTEMS

Hills Solar has taken advantage of the most recent improvements in solar heat transfer technology to bring you an advanced solar panel with the NEW Hills APOLLO™ flat panel solar hot water systems.

With its innovative design and advanced solar panel technology to capture the sun's natural energy, the Hills APOLLO™ can effectively reduce household CO2 emissions by up to 4 tonnes per year. That's the equivalent environmental benefit of taking a small car off the road.

The Hills APOLLO™ is designed to provide superior solar hot water performance for you and your family and will also look great and add value to your home.



THE IDEAL LOCATION FOR PANELS IS FACING DUE NORTH. However, 45° NW or NE is acceptable with minimal effect on performance.



Advanced Solar Technology

The Hills APOLLO™ represents the pinnacle in flat panel solar hot water systems in Australia.

Using advanced technology and innovative design, the Hills APOLLO™ delivers performance efficiencies that exceed those of comparable flat panel solar hot water systems.

Hills APOLLO™ uses single sheet collector panels which increase which increase absorption and reduce heat loss.

Hills APOLLO™ solar panels are a unique single piece base construction and are laser welded for optimal heat transfer.

High-density thermal insulation is used inside Hills APOLLO™ solar panels to minimise heat loss. Hills APOLLO™ is the smartest choice in flat panel solar hot water systems.

> How it works

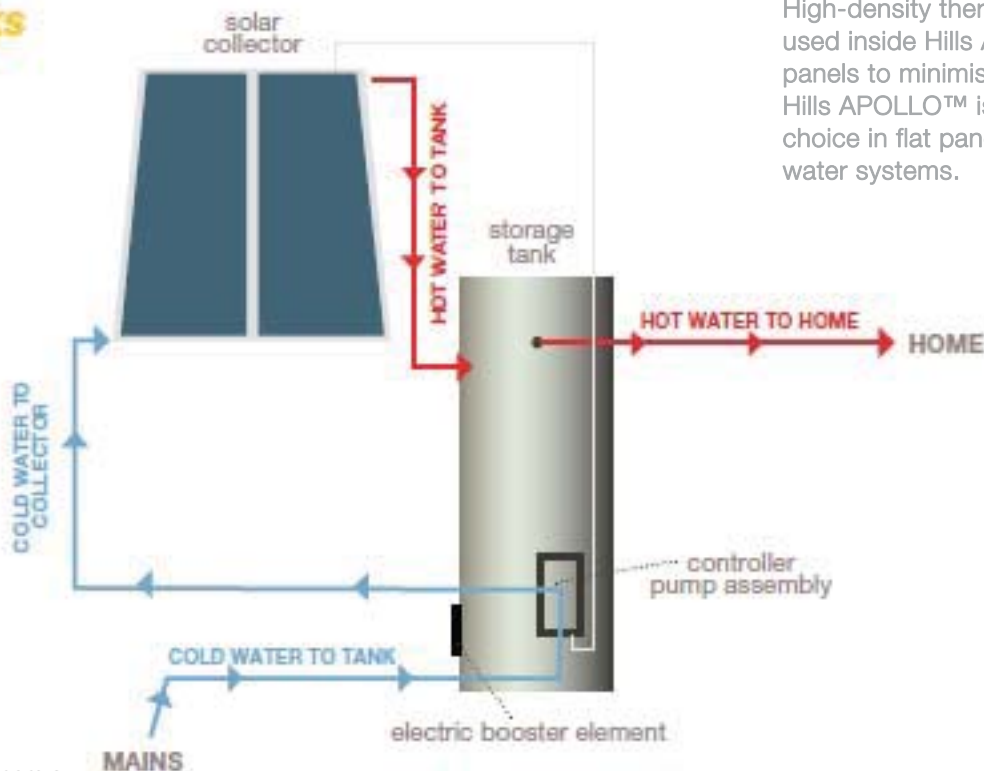

Hills Solar leading the way

Hills Solar has been the benchmark for solar hot water system efficiency, reliability and aesthetics since the introduction of the Hills ESTEEM™ evacuated tube solar hot water system in 2006.

Hills Solar combines progressive research and development and world-class manufacturing to deliver high performance, superior quality solar hot water systems.

The Hills APOLLO™ delivers outstanding durability and exceptional heating and efficiency ensuring a constant supply of hot water.

"The Hills APOLLO™ uses single sheet sun selective panels which increase absorption and reduce heat loss"

Hills APOLLO™ is available using a stainless steel storage tank – with a 10 year tank warranty.

Hills APOLLO™ is also available using a vitreous enamel (glass-lined) storage tank with sacrificial anode that is suitable for a wide range of water conditions – with a 7 year tank warranty.

You will have peace of mind with Hills APOLLO™ 7 year product warranty on the solar panels.

Gas and electric boosting

When radiant energy is low as a result of cloud cover or rain, the Hills APOLLO™ utilises gas or electric boosting to ensure a consistent supply of hot water.

The gas boosted Hills APOLLO™ system comes with a continuous flow gas booster that delivers up to 26 litres of hot water per minute to ensure your hot water is delivered at the required temperatures.

"Hot water available all year round"



Stainless Hot Water Storage Tank



Panels & Frames Vitreous Enamel (Glass Lined) Tanks





Hills Solar

*soak up
the sun*

Hills APOLLO™

FLAT PANEL SOLAR HOT WATER SYSTEMS.





Government incentives available
Superior flat panel solar hot water performance
Save up to 85% on hot water heating costs
Up to 10 year warranty on major components

Call us on 1300 363 386

hillssolar.com.au

Selection guide

*No. of Persons in a Household	*Tank Size	Number of panels
(up to 5 people) 	270 Litre Storage Tank	2 panels
(up to 7 people) 	340 Litre Storage Tank	2 to 3 panels

Based on AS3500.4:2003 Appendix H. Assuming 80% container draw off. Energy calculations are based on AS4234-1994.

* Suggested only. > Tank size shown denotes the rated tank capacity.

1 - Denomination could reflect a dishwasher or washing machine.

Generous Government Incentives

Governments all around Australia have introduced measures to increase the sustainability of new and existing housing with a focus on reducing energy consumption.

You may be eligible for Federal, State or Local Government rebates when installing a Hills APOLLO™ flat panel solar hot water system.

The Hills APOLLO™ solar hot water system qualifies for generous Government incentives.

Visit hillssolar.com.au or call **1300 363 386** for further information regarding Government incentives.

STCs (Small Scale Technology Certificates)

STCs are a form of currency created by the Federal Government under the Small Scale Technology (Electricity) Act 2000 and are used to demonstrate compliance with the requirements of the Governments Renewable Energy Target (RET) scheme. There are four zones within Australia, which will determine the amount of STCs per system.



> **What's your REC's zone?**



Flat Panel Solar Collector Technical Specifications



Panels
Frames

Total Area	2.02m ²
Number of Risers	10
Water that Collector Holds	1750ml
Absorber Surface	1.81m ²
Total Dimensions LxHxW	2010mmx1010mmx110mm
Collector Total Weight (without water)	38kg
Absorber	Sun-Selective
Absorber Coefficient	95% ± 2%
Radiation Coefficient	5% ± 2%
Maximum Operating Pressure	1000kPa



FLAT PANEL SOLAR COLLECTOR

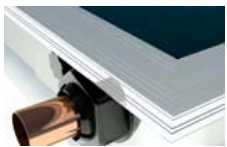

Aluminum
Frame

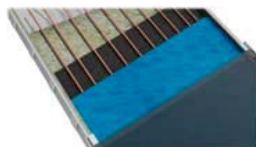

Sun Selective
Absorber & 10
Copper Risers



UV Proofed
Solar Glass
Rubber
Seal

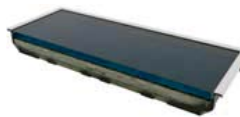

High Density
Thermal
Insulation



Tempered
Solar Glass



Aluminum
Trough



Standard Frame
(Supplied with each Hills APOLLO™ system)



A Frame
(for flat roof
installations –
optional extra)



Stainless Steel Storage Tanks Measurements



		265	330
A	Tank Height	1690mm	2090mm
B	Tank Diameter	600mm	600mm
C	Cold Water Inlet	210mm	210mm
D	Flow Line to Collector	650mm	650mm
E	Return Line from Collector	300mm	300mm
F	PTR Valve	1480mm	1880mm
G	Electric Boosted Tank Hot Water Outlet	1480mm	1880mm
	Gas Boosted Tank Hot Water Outlet	880mm	1270mm
H	Sensor Well	210mm	210mm
I	Gas Boosted Tank Gas Booster Flue Outlet	1345mm	1735mm
J	Gas Boosted Tank System Depth	795mm	795mm

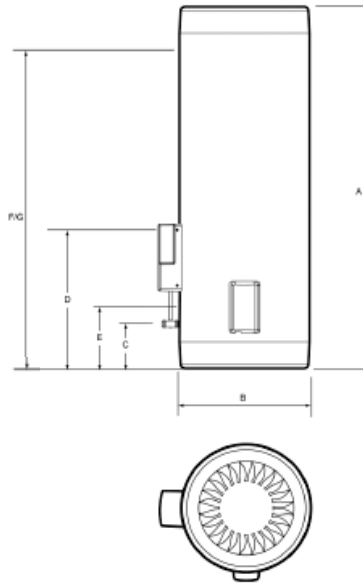

Figure 9 Electric boosted stainless steel storage tank

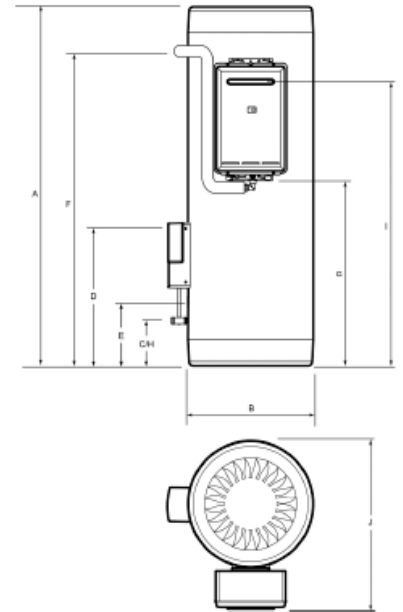

Figure 10 Gas boosted stainless steel storage tank

Vitreous Enamel (Glass Lined) Tanks Measurements



		270	340
A	Tank Height	1265mm	1510mm
B	Tank Diameter	685mm	685mm
C	Cold Water Inlet	260mm	260mm
D	Flow Line to Collector	700mm	700mm
E	Return Line from Collector	985mm	1230mm
F	PTR Valve	985mm	1230mm
G	Electric Boosted Tank Hot Water Outlet	985mm	1230mm
	Gas Boosted Tank Hot Water Outlet	675mm	920mm
H	Sensor Well	260mm	260mm
I	Gas Boosted Tank Gas Booster Flue Outlet	1135mm	1380mm
J	Gas Boosted Tank System Depth	879mm	879mm

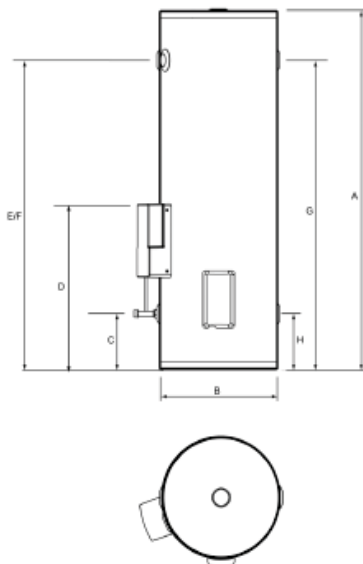

Figure 11 Electric boosted vitreous enamel storage tank

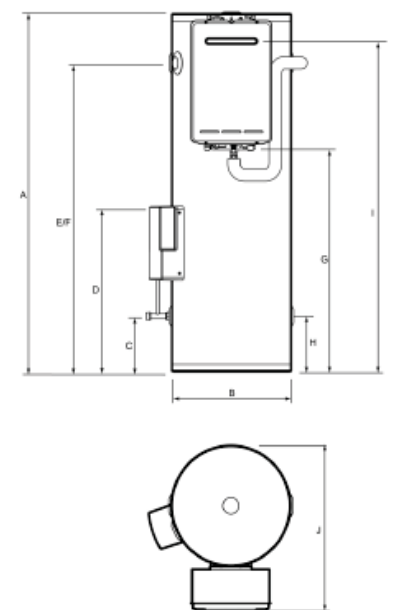

Figure 12 Gas boosted vitreous enamel storage tank